

indice

<i>Introduction</i>	4	Introduzione
<i>Mounting suggestions</i>	12	Suggerimenti per il montaggio
<i>Production program</i>	14	Programma di produzione
<i>Complete clamps standard series with upper plate</i>	17	Collari serie standard in polipropilene, con piastra superiore
<i>Complete clamps standard series</i>	19	Collari completi serie standard
<i>Complete stacking clamps standard series</i>	21	Collari completi raggruppati serie standard con piastra superiore raggruppato
<i>Special plates for standard series</i>	28	Piastre speciali per serie standard
<i>Complete clamps for twin tubes</i>	29	Collari completi standard per tubi gemellati
<i>Complete clamps double series</i>	31	Collari completi serie doppia
<i>Complete stacking clamps double series</i>	32	Collari completi serie doppi raggruppati
<i>Clamps for hoses, pipes, tubes and cables</i>	39	Elementi di fissaggio per tubi rigidi, flessibili e cavi elettrici
<i>Complete clamps heavy duty series</i>	41	Collari completi serie pesante
<i>Complete stacking clamps heavy duty series</i>	42	Collari completi raggruppati serie pesante
<i>Double plates for heavy duty series</i>	50	Piastre doppie per serie pesante
<i>Pipe clamps for cylinder</i>	51	Supporto tra tubo e cilindro
<i>Materials properties</i>	52	Caratteristiche materiali
<i>General sales conditions</i>	55	Condizioni generali di vendita

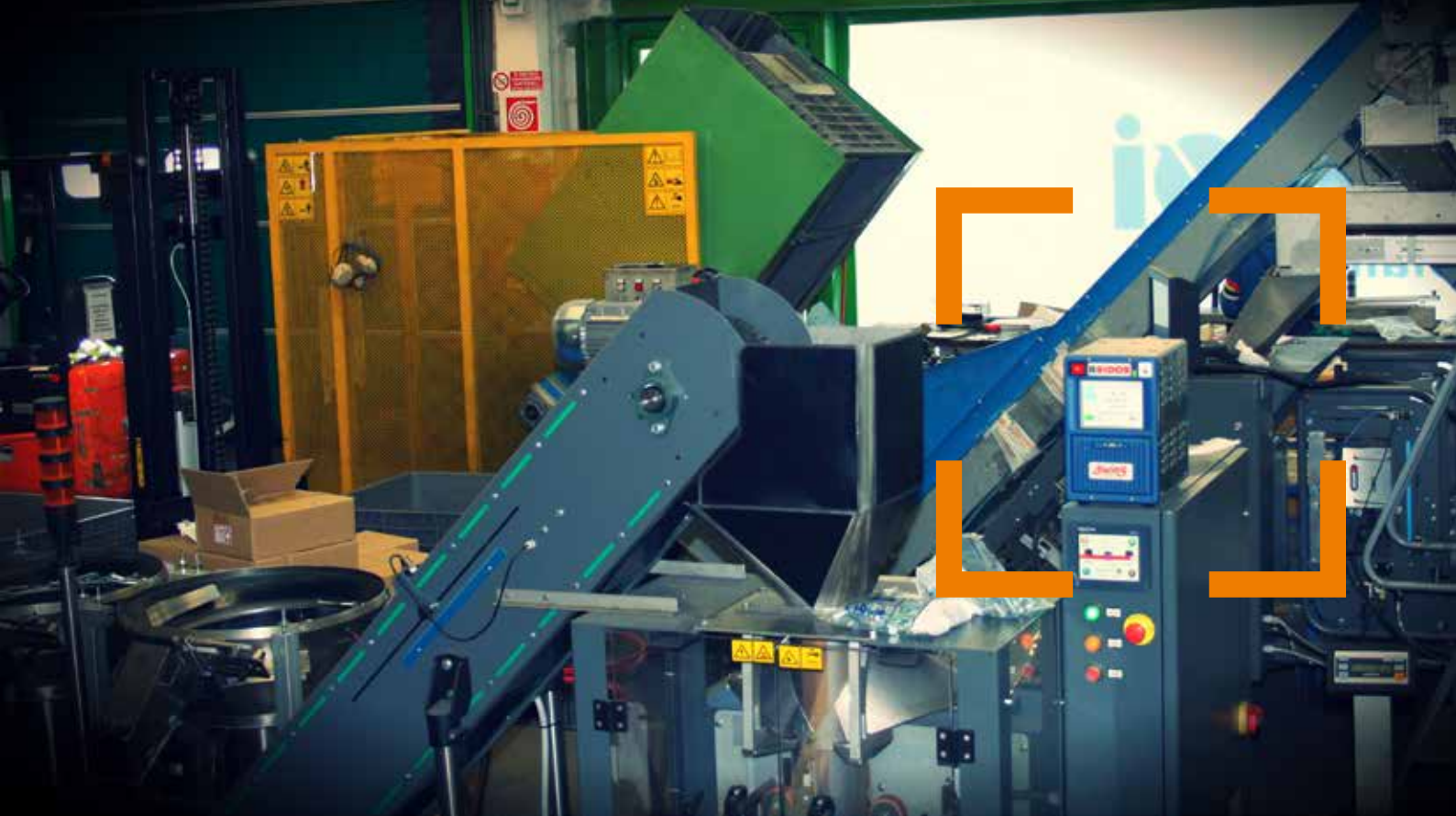



Clamps are a sensible and easy way for securing piping and hoses in all type of industries and on all types of terrestrial and marine installations.



staffe e collari



Le staffe e i collari sono di facile impiego e permettono di fissare tubi, cavi elettrici, guaine, canaline, ecc., in modo sicuro, rapido ed economico.

Esteticamente e tecnicamente valide, possono venir agganciate con la massima facilità su qualsiasi tipo di struttura fissa per mezzo di guide saldabili.

- Tutti i particolari sono costruiti con riferimento alle norme DIN 3015.

Clamps are fast to mount, easy and economic:

- *manufactured with reference to DIN 3015*
- *pleasant, practical and economical design*
- *using welding plates or rails, it's easy to fix the clamps to machines and plans*

I collari delle staffe AEGI vengono prodotti nei seguenti materiali:

- Polipropilene copolimero - di colore verde e nero - per la serie standard, pesante e doppia
- Poliammide - di colore nero - (Nylon 6-6 caricato al 20% con fibra di vetro, autoestinguente VO), per la serie standard, pesante e doppia
- Alluminio, per la serie leggera e pesante
- Gomma - di colore nero - per serie standard doppia e pesante.

AEGI pipe clamps are manufactured in:

- *Polypropylene - green or black colour - for standard, heavy duty and double series*
- *Polyamide - black colour - (Nylon 6-6 loaded with 20% of fiberglass self-extinguishing VO) for standard, heavy duty and double series*
- *Aluminium for standard and heavy duty series*
- *Rubber - black colour - for standard double and heavy duty series*



polipropilene
poliammide
alluminio
gomma

piastre e binari

Gli altri componenti delle staffe vengono prodotti, di serie, con i seguenti materiali:

- Piastra inf. e sup.: acciaio FE 36 e acciaio inox 316L
- Viti e rondelle: acciaio 8.8 e acciaio inox 304
- Binari: acciaio FE 36 e acciaio inox 304

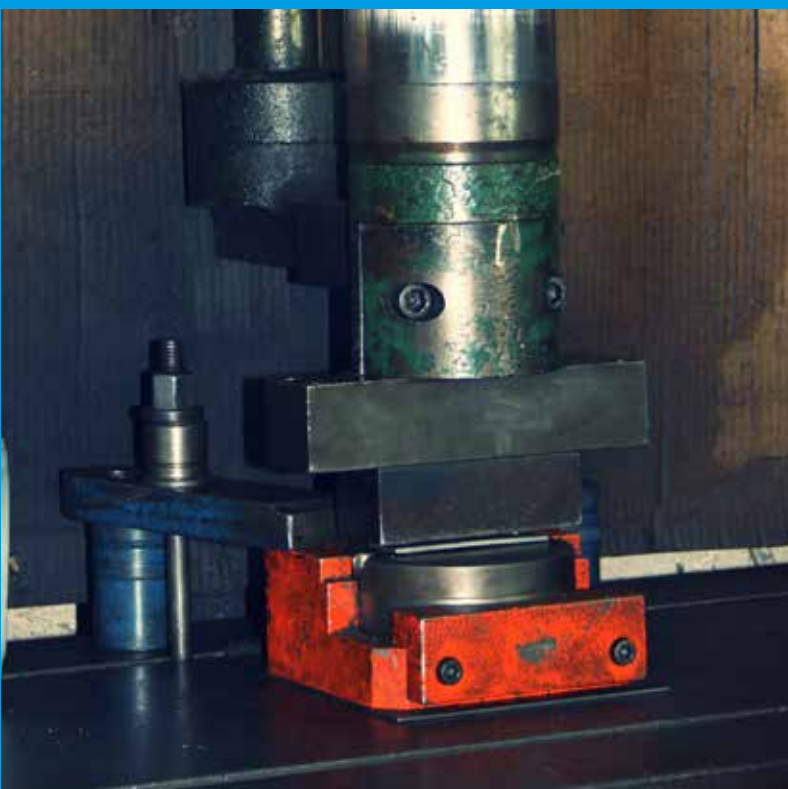

The other metallic components of the clamps are manufactured in:

- *Lower and upper plate: Steel FE 36 and stainless steel 316L*
- *Screw and washer: Steel 8.8 and stainless steel 304*
- *Rail: Steel FE 36 and stainless steel 304*

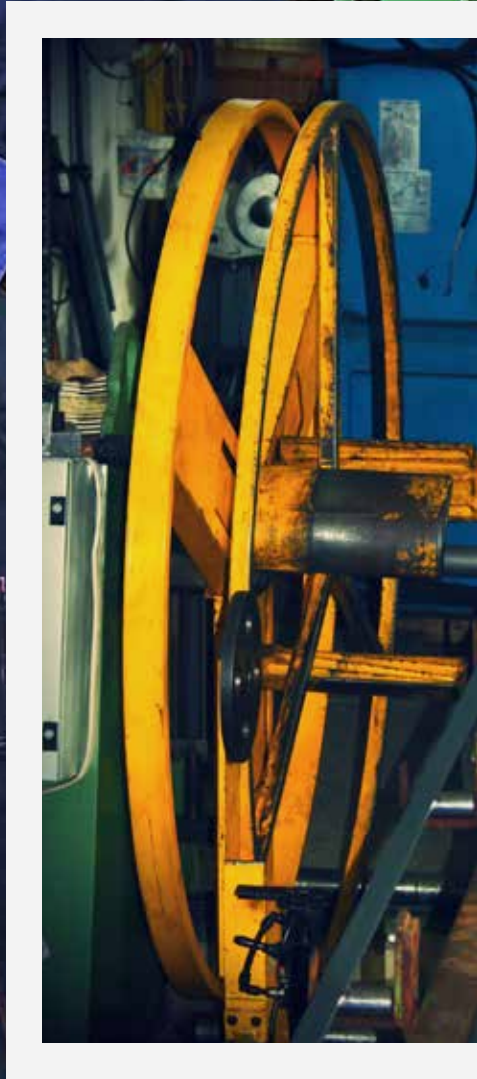



Suggerimenti per il montaggio

Montaggio con piastra a saldare

Posizionare la piastra inferiore nella posizione prescelta e bloccarla con un magnete o con un'appropriata attrezzatura. Saldare quindi la piastra. Inserire il semiguscio inferiore della staffa, posizionare il tubo, mettere il secondo semiguscio e serrare le viti. Non saldare la piastra inferiore con la staffa di plastica montata. Le piastre inferiori allungate possono essere avvitate direttamente sul telaio della macchina. Attenzione agli interassi dei tubi (si sconsiglia il contatto fra due semigusci).

Montaggio con binario

I binari sono forniti con lunghezza di 2 metri. Saldare o avvitare il binario sul telaio della macchina, inserire il dado scorrevole nel binario e girarlo leggermente in modo che non possa ruotare, inserire la parte inferiore della staffa, posizionare il tubo, mettere il secondo semiguscio e serrare le viti. Attenzione agli interassi dei tubi (si sconsiglia il contatto fra due semigusci).

Montaggio raggruppato

Consiste nel montare due staffe una sopra l'altra usando due viti speciali. Con questo montaggio si possono raggruppare due o più staffe bloccando le viti speciali con un'appropriata piastrina di sicurezza.

Mounting details

Weld plate mounting

Weld lower plate in position. Press on lower clamp half, lay tube, put on top clamp half, insert screws and tighten. Don't weld with plastic clamps on them. Prolonged lower plate can be screwed directly to the surface. Ensure the clamp halves are not in contact with each other.

Rails mounting

Mounting rails are supplied in 2m lengths. Weld or screw mounting rail in position. Insert nut into rail and turn to fix at correct spacing. Press on lower clamp half, lay tube, put on top clamp half, insert screw and tighten. Ensure the clamp halves are not in contact with each other.

Stacking

Consists of 2 clamp halves, stacking bolt(s) and a bolt locking plate. To construct a stack, fasten a weld plate or rail nut and locate 2 clamp halves and tube, securing with stacking bolt(s). Once tight, these bolts must be held with a locking plate. The next clamp can then be assembled and so on, until the stack is complete, the last clamp being secured with conventional bolt(s) and top plate.



Ø est. tubo Ø tube	Distanza fra le staffe in m Distances of clamps in meters
a 6 bis 12,7	0,9
a 15 bis 22	1,2
a 23 bis 28	1,5
a 30 bis 38,1	2
a 40 bis 48,3	2,5
a 50 bis 57	3
a 60 bis 70	3,4
a 76,1 bis 88,9	3,7
a 101,6 bis 108	4
a 114,3 bis 133	4,3
a 139,7 bis 165,1	5
a 168,3 bis 324	5,5

Distanza suggerita tra una staffa e l'altra dello stesso gruppo.
Posizionare le staffe prima e dopo una curva a 90° (a gomito).

*Recommend distance for installation of clamps of same group code.
When an elbow or bend be supported the clamps, should be positioned as close as possible on each side of the bend.*



Serie - Series			Nm/Material		
			Polypropylen	Polyamide	Aluminium
Standard		M 6	8	10	12
Doppia Twin	Gr. 1	M 6	5	6	-
	Gr. 2 ÷ 4	M 8	12	12	-
	Gr. 5		8	8	-
Pesante Heavy	Gr. 1	M 10	12	20	30
	Gr. 2		12	20	30
	Gr. 3		15	25	35
	Gr. 4	M 12	30	40	55
	Gr. 5	M 16	45	55	120
	Gr. 6	M 20	80	150	220
	Gr. 7	M 24	110	200	250
	Gr. 8	M 30	180	350	500
	Gr. 9	M 30	200	370	500

Max. momento torcente per il fissaggio delle viti. Staffe con piastra superiore.

Max. bolt tightening Torque in Nm, for clamps with upper plate.

Programma di produzione

Production program

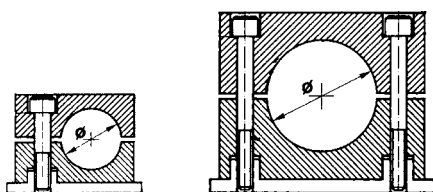

collari serie standard
standard clamps

DIN gruppo group	diametro tubo pipe diameter	
	Ø mm	foro nominale nominal bore Ø pollici inch. O.D.
0	6	
	8	5/16"
	10	G 1/8"
	12	
1	6	
	6,4	1/4"
	8	5/16"
	9,5	3/8"
	10	G 1/8"
	12	
2	12,7	1/2"
	13,5	G 1/4"
	14	
	15	
	16	5/8"
	17,2	G 3/8"
	18	
	19	
3	19	3/4"
	20	3/4"
	21,3	G 1/2"
	22	7/8"
	23	
	25	
	25,4	1"
4	26,9	G 3/4"
	28	
	30	
	32	1 1/4"
	32	1 1/4"
	33,7	G 1"
	35	
	38	1 1/2"
5	40	
	42	G 1 1/4"
	45	
	44,5	1 3/4"
	48,3	G 1 1/2"
6	50,8	2"

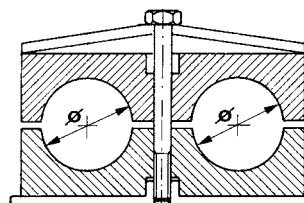

collari serie standard
standard clamps

DIN gruppo group	diametro tubo pipe diameter	
	Ø mm	foro nominale nominal bore Ø pollici inch. O.D.
1	6	
	6,4	1/4"
	8	5/16"
	9,5	3/8"
	10	G 1/8"
2	12	
	12,7	1/2"
	13,5	G 1/4"
	14	
	15	
	16	5/8"
3	17,2	G 3/8"
	18	
	19	3/4"
	20	
	21,3	G 1/2"
	22	7/8"
	25	
4	25,4	1"
	26,9	G 3/4"
	28	
	30	
	32	1 1/4"
	33,7	G 1"
5	35	
	38	1 1/2"
	40	
	42	G 1 1/4"
	44,5	1 3/4"

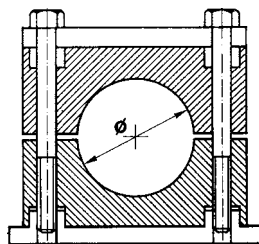

collari serie pesante
heavy duty clamps

DIN gruppo group	diametro tubo pipe diameter			DIN gruppo group	diametro tubo pipe diameter		
	Ø mm	foro nominale nominal bore	Ø pollici inch. O.D.		Ø mm	foro nominale nominal bore	Ø pollici inch. O.D.
1	6			5	65		
	6,4		1/4"		70		2 3/4"
	8		5/16"		73		
	9,5		3/8"		75		
	10	G 1/8"			76,1	G 2 1/2"	
	12				80		
	12,7		1/2"		82,5		3 1/4"
	13,5	G 1/4"			88,9	G 3"	3 1/2"
	14				88,9	G 3"	3 1/2"
	15				100		
	16		5/8"		101,6	G 3 1/2"	4"
	17,2	G 3/8"			108		4 1/4"
	18				114,3	G 4"	4 1/2"
	19		3/4"		127	G 4 1/2"	5"
	20				133		5 1/2"
2	21,3	G 1/2"		133		5 1/4"	
	22		7/8"	139,7	G 5"	5 1/2"	
	25		1"	152,4	G 5 1/2"	6"	
	25,4			165		6 1/2"	
	26,9	G 3/4"		168,3	G 6"		
	28			168,3	G 6"		
	30			177,8		7"	
	30			193,7		7 5/8"	
	32		1 1/4"	216		8 1/2"	
	33,7	G 1"		219,1	G 8"		
3	35						
	38		1 1/2"				
	40						
	42	G 1 1/4"					
	38		1 1/2"				
	42	G 1 1/4"					
	44,5		1 3/4"				
4	48,3	G 1 1/2"					
	50						
	50,8		2"				
	55						
	57		2 1/4"				
	60,3	G 2"					
	63,5		2 1/2"				
	65						
	70		2 3/4"				

Collari completi serie standard con piastra superiore

*Complete clamps standard series
with upper plate*

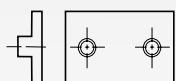

APIN
1

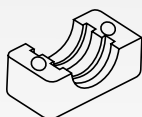

A.....S
2x

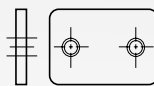

APS
1



AVTE
2x

A = polipropilene
polypropylene

MA = polyamide
self-extinguishing

RA = gomma
rubber

LA = alluminio
aluminium

Collari serie standard con piastra superiore in polipropilene, poliammide autoestinguente, gomma o alluminio

Standard clamps with upper plate in polypropylene, self-extinguishing polyamide, rubber or aluminium

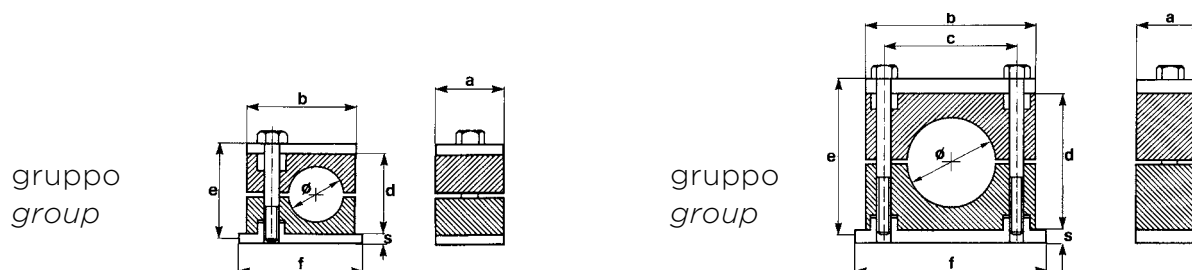

DIN gruppo group	diametro tubo pipe diameter		tipo di collare clamp type				dimensioni in mm dimension in mm						pezzi per confezione box quantity	
	Ø mm	pollici / inches G Ø O.D.	A polipropilene polypropylene	MA polyamide self-extinguishing	RA gomma rubber	LA alluminio aluminium	a	b	c	d	f	s		e
0	6		A0 06+APS	MA 0 06+APS	-	-	30	28	-	27	32	3	M6x30	50
	8	5/16"	A0 08+APS	MA0 08+APS	-	-								
	10	1/8"	A0 10+APS	MA0 10+APS	-	-								
	12		A0 12+APS	MA0 12+APS	-	-								
1	6		A1 06+APS	MA1 06+APS	RA1 06+APS	LA1 06+APS	30	35	20	27	42	3	M6x30	50
	6,4	1/4"	A1 6,4+APS	MA1 6,4+APS	RA1 6,4+APS	-								
	8	5/16"	A1 08+APS	MA1 08+APS	RA1 08+APS	LA1 08+APS								
	9,5	3/8"	A1 9,5+APS	MA1 9,5+APS	RA1 9,5+APS	-								
	10	1/8"	A1 10+APS	MA1 10+APS	RA1 10+APS	LA1 10+APS								
	12		A1 12+APS	MA1 12+APS	RA1 12+APS	LA1 12+APS								
2	12,7	1/2"	A2 12,7+APS	MA2 12,7+APS	RA2 12,7+APS	-	30	41	26	33	48	3	M6x35	50
	13,5	1/4"	A2 1/4"+APS	MA2 1/4"+APS	RA2 1/4"+APS	LA2 1/4"+APS								
	14		A2 14+APS	MA2 14+APS	RA2 14+APS	LA2 14+APS								
	15		A2 15+APS	MA2 15+APS	RA2 15+APS	LA2 15+APS								
	16	5/8"	A2 16+APS	MA2 16+APS	RA2 16+APS	LA2 16+APS								
	17,2	3/8"	A2 3/8"+APS	MA2 3/8"+APS	RA2 3/8"+APS	LA2 3/8"+APS								
	18		A2 18+APS	MA2 18+APS	RA2 18+APS	LA2 18+APS								
	19	3/4"	A2 19+APS	MA2 19+APS	RA2 19+APS	-								
3	19	3/4"	A3 19+APS	MA3 19+APS	RA3 19+APS	LA3 19+APS	30	48	33	35	55	3	M6x40	50
	20		A3 20+APS	MA3 20+APS	RA3 20+APS	LA3 20+APS								
	21,3	1/2"	A3 1/2"+APS	MA3 1/2"+APS	RA3 1/2"+APS	LA3 1/2"+APS								
	22	7/8"	A3 22+APS	MA3 22+APS	RA3 22+APS	LA3 22+APS								
	23		A3 23+APS	MA3 23+APS*	RA3 23+APS*	-								
	25		A3 25+APS	MA3 25+APS	RA3 25+APS	LA3 25+APS								
	25,4	1"	A3 25,4+APS	MA3 25,4+APS	RA3 25,4+APS	-								
4	26,9	3/4"	A4 3/4"+APS	MA4 3/4"+APS	RA4 3/4"+APS	LA4 3/4"+APS	30	57	40	42	62	3	M6x45	25
	28		A4 28+APS	MA4 28+APS	RA4 28+APS	LA4 28+APS								
	30		A4 30+APS	MA4 30+APS	RA4 30+APS	LA4 30+APS								
	32	1 1/4"	A4 32+APS	MA4 32+APS	RA4 32+APS	LA4 32+APS								
5	32	1"	A5 32+APS	MA5 32+APS	RA5 32+APS	LA5 32+APS	30	69	52	58	74	3	M6x60	25
	33,7		A5 1"+APS	MA5 1"+APS	RA5 1"+APS	LA5 1"+APS								
	35		A5 35+APS	MA5 35+APS	RA5 35+APS	LA5 35+APS								
	38	1 1/2"	A5 38+APS	MA5 38+APS	RA5 38+APS	LA5 38+APS								
	40		A5 40+APS	MA5 40+APS	RA5 40+APS	LA5 40+APS								
	42	1 1/4"	A5 11/4"+APS	MA5 11/4"+APS	RA5 11/4"+APS	LA5 11/4"+APS								
	45		A5 45+APS	MA5 45+APS	RA5 45+APS	LA5 45+APS								
6	44,5	1 3/4"	A6 44,5+APS	MA6 44,5+APS	RA6 44,5+APS	LA6 44,5+APS	30	86	66	66	88	3	M6x70	25
	48,3	1 1/2"	A6 11/2"+APS	MA6 11/2"+APS	RA6 11/2"+APS	LA6 11/2"+APS								
	50,8	2"	A6 50,8+APS	MA6 50,8+APS	RA6 50,8+APS	LA6 50,8+APS								

* on request with minimum quantity - articolo a richiesta con quantitativo minimo

Collari completi serie standard

Complete clamps standard series

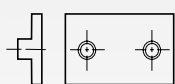

APIN
1

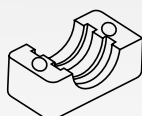

A.....S
2x



AROND
2x



AVTC
2x

A = polipropilene
polypropylene

MA = polyamide
self-extinguishing

RA = gomma
rubber

LA = alluminio
aluminium

Collari serie standard in polipropilene,
poliammide autoestinguente, gomma o alluminio

Standard clamps in polypropylene,
self-extinguishing polyamide, rubber or aluminium

gruppo
group

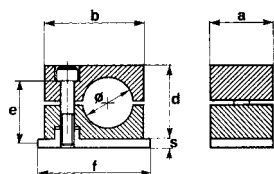

gruppo
group

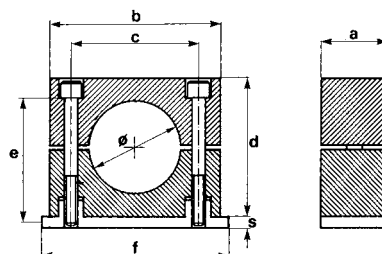

DIN gruppo group	diametro tubo pipe diameter		tipo di collare clamp type				dimensioni in mm dimension in mm							pezzi per confezione box quantity					
	Ø mm	pollici / inches G Ø O.D.	A polipropilene polypropylene	MA polyamide self-extinguishing	RA gomma rubber	LA alluminio aluminium	a	b	c	d	f	s	e						
0	6		A0 06	MA 0 06	-	-									50				
	8		A0 08	MA0 08	-	-								M6x20					
	10	1/8"	A0 10	MA0 10	-	-	30	28	-	27	31,5	3							
	12		A0 12	MA0 12	-	-													
1	6		A1 06	MA1 06	RA1 06	LA1 06									50				
	6,4		A1 6,4	MA1 6,4	RA1 6,4	-							M6x20						
	8	1/4"	A1 08	MA1 08	RA1 08	LA1 08								50					
	9,5	3/8"	A1 9,5	MA1 9,5	RA1 9,5	-										M6x20			
	10	1/8"	A1 10	MA1 10	RA1 10	LA1 10											50		
	12		A1 12	MA1 12	RA1 12	LA1 12												M6x25	
2	12,7	1/2"	A2 12,7	MA2 12,7	RA2 12,7	-									50				
	13,5	1/4"	A2 1/4"	MA2 1/4"	RA2 1/4"	LA2 1/4"							M6x25						
	14		A2 14	MA2 14	RA2 14	LA2 14								50					
	15		A2 15	MA2 15	RA2 15	LA2 15										M6x25			
	16	5/8"	A2 16	MA2 16	RA2 16	LA2 16											50		
	17,2	3/8"	A2 3/8"	MA2 3/8"	RA2 3/8"	LA2 3/8"												M6x25	
	18		A2 18	MA2 18	RA2 18	LA2 18													50
	19	3/4"	A2 19	MA2 19	RA2 19	-													
3	19	3/4"	A3 19	MA3 19	RA3 19	LA3 19									50				
	20		A3 20	MA3 20	RA3 20	LA3 20							M6x30						
	21,3	1/2"	A3 1/2"	MA3 1/2"	RA3 1/2"	LA3 1/2"								50					
	22	7/8"	A3 22	MA3 22	RA3 22	LA3 22										M6x30			
	23		A3 23	MA3 23*	RA3 23*	-											50		
	25		A3 25	MA3 25	RA3 25	LA3 25												M6x35	
4	25,4		A3 25,4	MA3 25,4	RA3 25,4	-									25				
	26,9	3/4"	A4 3/4"	MA4 3/4"	RA4 3/4"	LA4 3/4"							M6x35						
	28		A4 28	MA4 28	RA4 28	LA4 28								25					
	30		A4 30	MA4 30	RA4 30	LA4 30										M6x35			
5	32	1 1/4"	A4 32	MA4 32	RA4 32	LA4 32									25				
	32	1 1/4"	A5 32	MA5 32	RA5 32	LA5 32							M6x50						
	33,7	1"	A5 1"	MA5 1"	RA5 1"	LA5 1"								25					
	35		A5 35	MA5 35	RA5 35	LA5 35										M6x50			
	38	1 1/2"	A5 38	MA5 38	RA5 38	LA5 38											25		
	40		A5 40	MA5 40	RA5 40	LA5 40												M6x50	
6	42	1 1/4"	A5 11/4"	MA5 11/4"	RA5 11/4"	LA5 11/4"									25				
	45		A5 45	MA5 45	RA5 45	LA5 45							M6x60						
	44,5	1 3/4"	A6 44,5	MA6 44,5	RA6 44,5	LA6 44,5								25					
	48,3		A6 11/2"	MA6 11/2"	RA6 11/2"	LA6 11/2"										M6x60			
50,8	1 1/2"	A6 50,8	MA6 50,8	RA6 50,8	LA6 50,8							25							

* on request with minimum quantity - articolo a richiesta con quantitativo minimo

Collari completi serie standard con piastra superiore raggruppato

Complete stacking clamps standard series

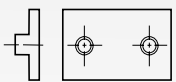

APIN
1

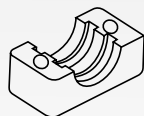

A.....S
4x



APMRS
1x

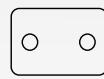

APS
1x



AVTE
2x



AVTEA
2x

A = polipropilene
polypropylene

MA = polyamide
self-extinguishing

RA = gomma
rubber

LA = alluminio
aluminium

A.....S



tipo H interno liscio
H model smooth inside



tipo normale interno sagomato
normal model profiled inside

DIN gruppo	semi-collare clamp-half	DIN gruppo	semi-collare clamp-half	
0	A0 06 S	3	A3 19 S	
	A0 08 S		A3 20 S	
	A0 10 S		A3 1/2" S	
	A0 12 S		A3 22 S	
1	A1 06 S	4	A3 23 S	
	A1 6,4 S		A3 25 S	
	A1 08 S		A3 25,4 S	
	A1 9,5 S		A4 3/4" S	
	A1 10 S		A4 28 S	
	A1 12 S		A4 30 S	
2	A2 12,7 S	5	A4 32 S	
	A2 1/4" S		A5 32 S	
	A2 14 S		A5 1" S	
	A2 15 S		A5 35 S	
	A2 16 S		A5 38 S	
	A2 3/8" S		A5 40 S	
	A2 18 S		A5 11/4" S	
	A2 19 S		A5 45 S	
	6			A6 44,5 S
				A6 11/2" S
		A6 50,8 S		

A.....C



tipo H interno liscio
H model smooth inside



tipo normale interno sagomato
normal model profiled inside

DIN gruppo	coppia collari clamp body (2 halves)	DIN gruppo	coppia collari clamp body (2 halves)	
0	A0 06 C	3	A3 19 C	
	A0 08 C		A3 20 C	
	A0 10 C		A3 1/2" C	
	A0 12 C		A3 22 C	
1	A1 06 C	4	A3 23 C	
	A1 6,4 C		A3 25 C	
	A1 08 C		A3 25,4 C	
	A1 9,5 C		A4 3/4" C	
	A1 10 C		A4 28 C	
	A1 12 C		A4 30 C	
2	A2 12,7 C	5	A4 32 C	
	A2 1/4" C		A5 32 C	
	A2 14 C		A5 1" C	
	A2 15 C		A5 35 C	
	A2 16 C		A5 38 C	
	A2 3/8" C		A5 40 C	
	A2 18 C		A5 11/4" C	
	A2 19 C		A5 45 C	
	6			A6 44,5 C
				A6 11/2" C
		A6 50,8 C		

APIN

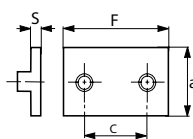
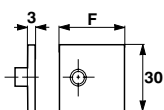

DIN gruppo
group **piastra inferiore**
lower plate

DIN gruppo group	APIN	F mm	c mm
0	APIN0	32	-
1	APIN1	41	20
2	APIN2	46	26
3	APIN3	54	33
4	APIN4	61	40
5	APIN5	73	52
6	APIN6	89	66

APIA

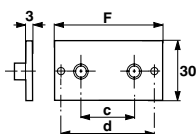
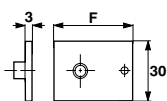

DIN gruppo
group **piastra inferiore allungata**
prolonged lower plate

DIN gruppo group	APIA	F mm	c mm	d mm
0	APIA0	46	-	-
1	APIA1	64	20	51
2	APIA2	70	26	56
3	APIA3	78	33	64
4	APIA4	87	40	73
5	APIA5	100	52	86
6	APIA6	115	66	100

APID

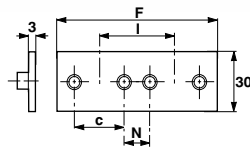

DIN gruppo group	<i>piastra inferiore doppia</i> <i>double lower plate</i>					
	APID	F mm	c mm	N mm	l mm	n° collari clamps
0	APID0	62	-	-	30	2
1	APID1	82	20	20	40	2
2	APID2	92	26	18	44	2
3	APID3	106	33	19	52	2
4	APID4	122	40	20	60	2
5	APID5	146	52	23	75	2
6	APID6	178	66	24	90	2

APIM

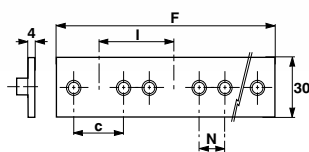

DIN gruppo group	<i>piastra inferiore multipla</i> <i>multiple lower plate</i>					
	APIM	F mm	c mm	N mm	l mm	n° collari clamps
0	APIM0	307	-	-	30	10
1	APIM1	410	20	20	40	10
2	APIM2	460	26	18	44	10
3	APIM3	540	33	19	52	10
4	APIM4	305	40	20	60	5
5	APIM5	365	52	23	75	5
6	APIM6	449	66	24	90	5

APS

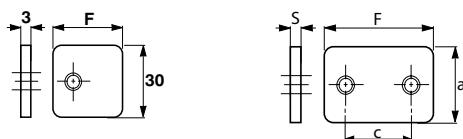

DIN gruppo group	piastra superiore upper plate		
	APS	F mm	c mm
0	APS0	28	-
1	APS1	37	20
2	APS2	43	26
3	APS3	50	33
4	APS4	57	40
5	APS5	69	52
6	APS6	83	66

AVTC

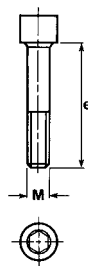

DIN gruppo group	vite a testa tonda esagono interno T.C.E.I. screws		
	AVTC	M	e mm
0	AVTC0	M6	20
1	AVTC1	M6	20
2	AVTC2	M6	25
3	AVTC3	M6	30
4	AVTC4	M6	35
5	AVTC5	M6	50
6	AVTC6	M6	60

AVTE

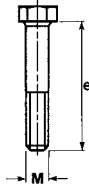

DIN gruppo
group vite a testa esagonale
hexagonal head screw

DIN gruppo group	AVTE	M	e mm
0	AVTE0	M6	30
1	AVTE1	M6	30
2	AVTE2	M6	35
3	AVTE3	M6	40
4	AVTE4	M6	45
5	AVTE5	M6	60
6	AVTE6	M6	70

AVTEA

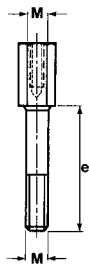

DIN gruppo
group vite a testa esag.
allungata
high hexeg. head
screw

DIN gruppo group	AVTEA	M	e mm
0	AVTEA0	M6	20
1	AVTEA1	M6	20
2	AVTEA2	M6	25
3	AVTEA3	M6	30
4	AVTEA4	M6	35
5	AVTEA5	M6	50
6	AVTEA6	M6	60

APMRS

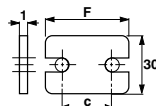

DIN gruppo
group

piastra superiore di sicurezza
security upper plate

	APMRS	c	mm
0	APMRS0	28	-
1	APMRS1	34	20
2	APMRS2	41	26
3	APMRS3	47	33
4	APMRS4	57	40
5	APMRS5	67	52
6	APMRS6	82	66

ABINS

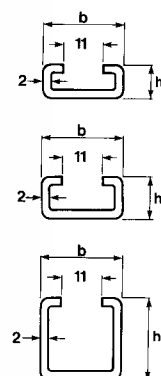

DIN gruppo
group

binari portanti
spessore 2 mm rail

	ABINS	B	H
		mm	mm
1	ABINS-1	28	11
2	ABINS-2	28	14
3	ABINS-3	28	30

ADES

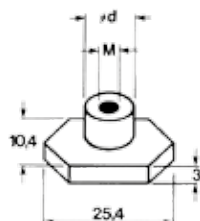

dado esagonale fissaggio binari
hexagonal nut

	ADES	M	ø
			mm
	ADES	M6	12

Piastre speciali per serie standard

Special plates for standard series

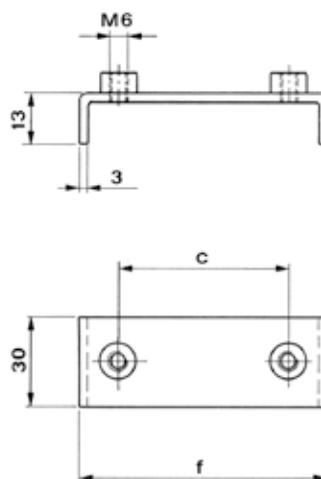
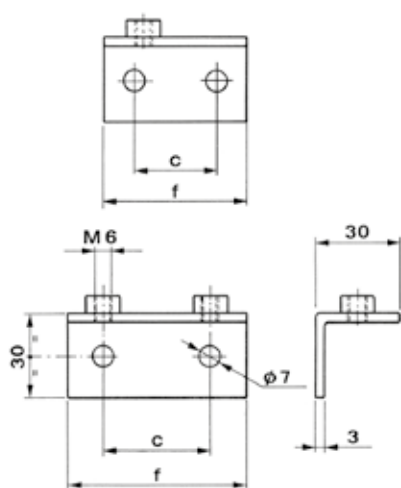

piastra ad angolo
angled plate

DIN gruppo group	APINL	c mm	f mm
0	APINL0	14	32
1	APINL1	20	42
2	APINL2	26	48
3	APINL3	33	55
4	APINL4	40	62
5	APINL5	52	74
6	APINL6	66	88

piastra ad angolo
angled plate

DIN gruppo group	APINB	c mm	f mm
0	APINB0	-	-
1	APINB1	20	49
2	APINB2	26	55
3	APINB3	33	63
4	APINB4	40	72
5	APINB5	52	86
6	APINB6	66	99

Collari completi serie doppia Complete clamp standard serie



ADPIN
1

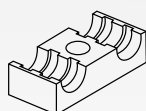

AD...S
2x

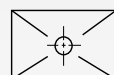

ADPS
1x



ADVTE
1x

AD = polipropilene
polypropylene

MD = polyamide
self-extinguishing

RD = gomma
rubber

Collari completi serie doppi raggruppati

Complete stacking clamps double series

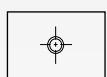

ADPIN
1

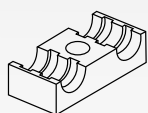

AD...S
4x

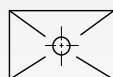

ADPS
1x



ADVTE
1x



APMRSD
1x



ADVTEA
1x

AD = polipropilene
polypropylene

MD = polyamide
self-extinguishing

RD = gomma
rubber

Collari doppi in polipropilene,
poliammide autoestinguente o gomma

*Double clamps in polypropylene,
self-extinguishing polyamide or rubber*

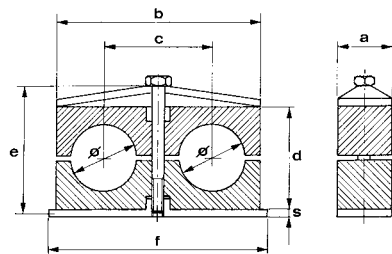

DIN gruppo group	diametro tubo pipe diameter		tipo di collare clamp type			dimensioni in mm dimension in mm							pezzi per confezione box quantity
	Ø mm	pollici / inches G Ø O.D.	AD polipropilene polypropylene	MD polyamide self-extinguishing	RD gomma rubber	a	b	c	d	f	s	e	
1	6-6		AD1 06-06	MD1 06-06	RD1 06-06	30	36	20	25	37	3	M6x35	50
	6,4-6,4	1/4 - 1/4"	AD1 6,4-6,4	MD1 6,4-6,4	RD1 6,4-6,4								
	8-8	5/16 - 5/16"	AD1 08-08	MD1 08-08	RD1 08-08								
	9,5-9,5	3/8 - 3/8"	AD1 9,5-9,5	MD1 9,5-9,5	RD1 9,5-9,5								
	10-10	1/8 - 1/8"	AD1 10-10	MD1 10-10	RD1 10-10								
	12-12		AD1 12-12	MD1 12-12	RD1 12-12								
2	12,7	1/2 - 1/2"	AD2 12,7-12,7	MD2 12,7-12,7	RD2 12,7-12,7	30	53	29	26	55	5	M8x35	50
	13,5	1/4 - 1/4"	AD2 1/4 - 1/4"	MD2 1/4 - 1/4"	RD2 1/4 - 1/4"								
	14-14		AD2 14-14	MD2 14-14	RD2 14-14								
	15-15		AD2 15-15	MD2 15-15	RD2 15-15								
	16-16	5/8 - 5/8"	AD2 16-16	MD2 16-16	RD2 16-16								
	17,2-17,2	3/8 - 3/8"	AD2 3/8 - 3/8"	MD2 3/8 - 3/8"	RD2 3/8 - 3/8"								
3	18-18		AD2 18-18	MD2 18-18	RD2 18-18	30	67	36	37	70	5	M8x45	50
	19-19	3/4 - 3/4"	AD3 19-19	MD3 19-19	RD3 19-19								
	20-20		AD3 20-20	MD3 20-20	RD3 20-20								
	21,3-21,3	1/2 - 1/2"	AD3 1/2 - 1/2"	MD3 1/2 - 1/2"	RD3 1/2 - 1/2"								
	22-22	7/8 - 7/8"	AD3 22-22	MD3 22-22	RD3 22-22								
4	25,4-25,4	1 - 1"	AD3 25,4-25,4	MD3 25,4-25,4	RD3 25,4-25,4	30	82	45	42	85	5	M8x50	25
	26,9	3/4 - 3/4"	AD4 3/4 - 3/4"	MD4 3/4 - 3/4"	RD4 3/4 - 3/4"								
	28-28		AD4 28-28	MD4 28-28	RD4 28-28								
	30-30		AD4 30-30	MD4 30-30	RD4 30-30								
5	32-32	1 1/4 - 1 1/4"	AD5 32-32	MD5 32-32	RD5 32-32	30	106	56	54	110	5	M8x60	25
	33,7-33,7	1 - 1"	AD5 1 - 1"	MD5 1 - 1"	RD5 1 - 1"								
	35-35		AD5 35-35	MD5 35-35	RD5 35-35								
	38-38	1 1/2 - 1 1/2"	AD5 38-38	MD5 38-38	RD5 38-38								
	40-40		AD5 40-40	MD5 40-40	RD5 40-40								
	42-42	1 1/4 - 1 1/4"	AD5 1 1/4 - 1 1/4"	MD5 1 1/4 - 1 1/4"	RD5 1 1/4 - 1 1/4"								

AD...S



tipo H interno liscio
H model smooth inside



tipo normale interno sagomato
normal model profiled inside

DIN gruppo	semi-collare clamp-half	DIN gruppo	semi-collare clamp-half
1	AD1 06-06 S	4	AD4 3/4 - 3/4" S
	AD1 6,4-6,4 S		AD4 28-28 S
	AD1 08-08 S		AD4 30-30 S
	AD1 9,5-9,5 S	5	AD5 32-32 S
	AD1 10-10 S		AD5 1 - 1" S
	AD1 12-12 S		AD5 35-35 S
AD2 12,7-12,7 S	AD5 38-38 S		
AD2 1/4 - 1/4" S	AD5 40-40 S		
2	AD2 14-14 S	5	AD5 11/4 - 1 1/4" S
	AD2 15-15 S		
	AD2 16-16 S		
	AD2 3/8 - 3/8" S		
	AD2 18-18 S		
	AD3 19-19 S		
3	AD3 20-20 S		
	AD3 1/2 - 1/2" S		
	AD3 22-22 S		
	AD3 25-25 S		
	AD3 25,4-25,4 S		

AD...C



tipo H interno liscio
H model smooth inside



tipo normale interno sagomato
normal model profiled inside

DIN gruppo	coppia-collare clamp-body (2 halves)	DIN gruppo	coppia-collare clamp-body (2 halves)
1	AD1 06-06 C	4	AD4 3/4 - 3/4" C
	AD1 6,4-6,4 C		AD4 28-28 C
	AD1 08-08 C		AD4 30-30 C
	AD1 9,5-9,5 C	5	AD5 32-32 C
	AD1 10-10 C		AD5 1 - 1" C
	AD1 12-12 C		AD5 35-35 C
AD2 12,7-12,7 C	AD5 38-38 C		
AD2 1/4 - 1/4" C	AD5 40-40 C		
2	AD2 14-14 C	5	AD5 11/4 - 1 1/4" C
	AD2 15-15 C		
	AD2 16-16 C		
	AD2 3/8 - 3/8" C		
	AD2 18-18 C		
	AD3 19-19 C		
3	AD3 20-20 C		
	AD3 1/2 - 1/2" C		
	AD3 22-22 C		
	AD3 25-25 C		
	AD3 25,4-25,4 C		

ADPIN

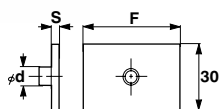

DIN gruppo group	piastra inferiore lower plate			
	ADPIN	F mm	Ø mm	S
1	ADPIN1	30	12	3
2	ADPIN2	55	14	5
3	ADPIN3	70	14	5
4	ADPIN4	85	14	5
5	ADPIN5	110	14	5

ADPS

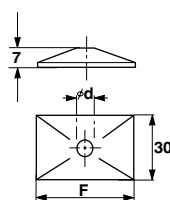

DIN gruppo group	piastra superiore upper plate		
	ADPS	F mm	Ø mm
1	ADPS1	35	7
2	ADPS2	52	9
3	ADPS3	66	9
4	ADPS4	81	9
5	ADPS5	105	9

ADPIM

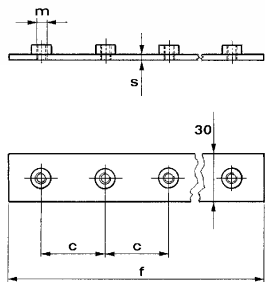

piastra inferiore multipla
multiple lower plate

DIN gruppo group	ADPIM	F	c	s	m	n° collari clamps
		mm	mm	mm	mm	
1	ADPIM1	198	40	3	M6	5
2	ADPIM2	288	58	5	M8	5
3	ADPIM3	360	72	5	M8	5
4	ADPIM4	447	90	5	M8	5
5	ADPIM5	557	112	5	M8	5

ADVTE

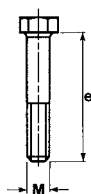

vite a testa esagonale
hexagonal head screw

DIN gruppo group	ADVTE	M	e
		mm	mm
1	ADVTE1	M6	35
2	ADVTE2	M8	35
3	ADVTE3	M8	45
4	ADVTE4	M8	50
5	ADVTE5	M8	60

ADVTEA

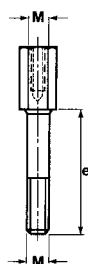

DIN gruppo
group *vite a testa esag. allungata*
high hexeg. head screw

	ADVTEA	M	e mm
1	ADVTEA1	M6	20
2	ADVTEA2	M8	20
3	ADVTEA3	M8	29
4	ADVTEA4	M8	34
5	ADVTEA5	M8	47

APMRSD

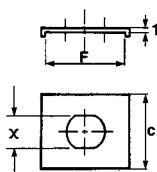

DIN gruppo
group *piastra superiore di sicurezza*
security upper plate

	APMRSD	F mm	c mm	d mm
1	APMRSD1	30	30	11
2	APMRSD2	30	30	13
3	APMRSD3	30	30	13
4	APMRSD4	30	30	13
5	APMRSD5	30	30	13

ABINS

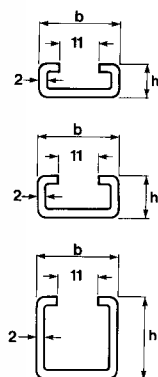

DIN gruppo group	binari portanti spessore 2 mm rail		
	ABINS	B mm	H mm
1	ABINS-1	28	11
2	ABINS-2	28	14
3	ABINS-3	28	30

ADES

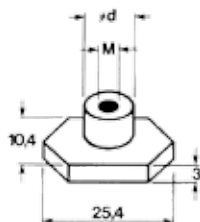

DIN gruppo group	dado esagonale fissaggio binari hexagonal nut		
	ADES	M	∅ mm
1	ADES	M6	12
2	ADES	M8	14

Elementi di fissaggio per tubi rigidi, flessibili e cavi elettrici

Clamps for hoses, pipes, tubes and cables

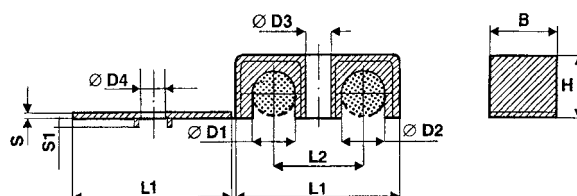

diametro tubo pipe diameter		tipo di collare clamp type	dimensioni in mm dimension in mm										colore colour
∅ mm	pollici / inches ∅ O.D.	ACSD polipropilene polypropylene	L1	L2	B	H	S	S1	D1	D2	D3	D4	
06 - 06	1/4 - 1/4	ACSD 06 - 06	38	22	16	14,2	2	3	6	6	6,9	7	nero/black
08 - 08	1/4 - 1/4	ACSD 08 - 08	38	22	16	14,5	2	3	10	10	6,9	7	nero/black
10 - 10	3/8 - 3/8	ACSD 10 - 10	53	31	20	22,5	2	3	15	15	6,9	7	nero/black
12 - 12	3/8 - 3/8	ACSD 12 - 12	70	38	20	30	2	3	19	19	6,9	7	nero/black

Applicazioni: Oleodinamica e pneumatica, Strumentazione, Tecnologia automobilistica, Industria Macchine Utensili, Macchine per plastica, Macchine movimento terra, Macchine agricole, Lubrificazione, Ingegneria meccanica, ecc.

Applications: Oleodynamics and pneumatics, Instrumentation and Automotive Technology, Machine Tool Industry, Gooseneck machines, Earth moving machines, Farm machines, Lubrication, Mechanical Engineering, and so on.

Collari completi serie pesante

Complete clamps heavy duty series

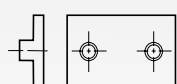
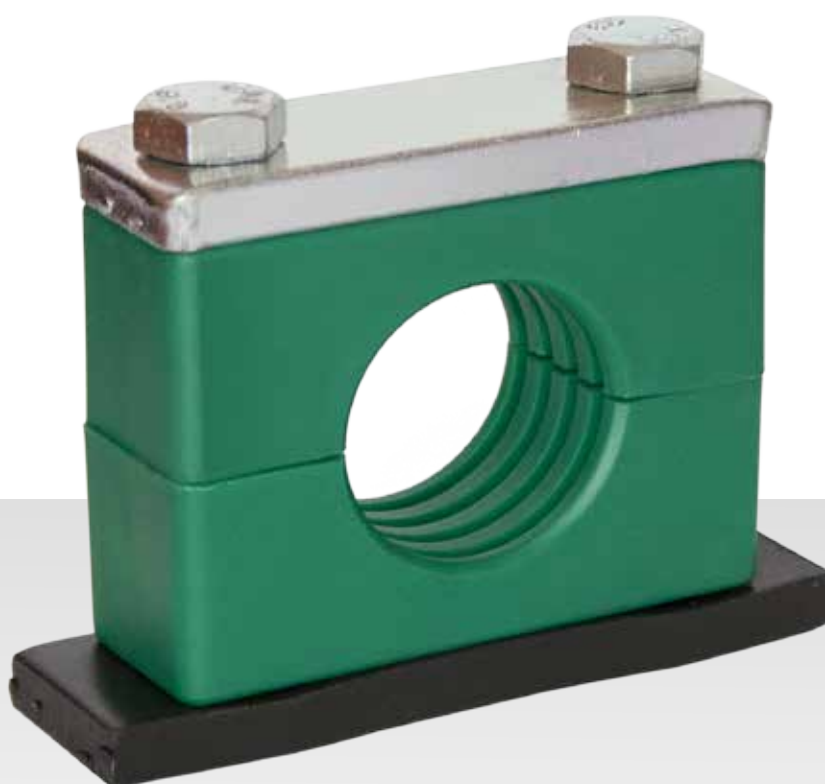

APINP
1

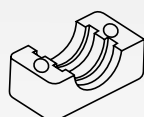

AMP.P....S
2x

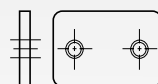

APSP
1



AVTEP
2x

AMP.P = polipropilene
polypropylene

MMP.P = polyamide
self-extinguishing

RMP.P = gomma
rubber

AMLL.P = alluminio
aluminium

Collari completo serie pesante raggruppato

Complete stacking clamps heavy duty series

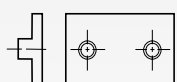

APINP
1



AMP.P....S
4x



APMRSP
1x

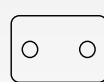

APSP
1x



AVTEP
2x



AVTEAP
2x

AMP.P = polipropilene
polypropylene

MMP.P = polyamide
self-extinguishing

RMP.P = gomma
rubber

AMLL.P = alluminio
aluminium

Collari serie pesante in polipropilene,
poliammide autoestinguente, alluminio o gomma

*Heavy duty clamps in polypropylene,
self-extinguishing polyamide, aluminium or rubber*

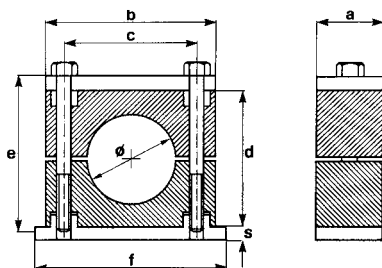

DIN gruppo group	diametro tubo pipe diameter		tipo di collare clamp type				dimensioni in mm dimension in mm						
	ϕ mm	pollici / inches G ϕ O.D.	AMP.P polipropilene polypropylene	MMP.P polyamide self-extinguishing	RMP.P gomma rubber	AMLL.P alluminio aluminium	a	b	c	d	f	s	e
1	6		AMP.P1 06	MMP.P1 06	RMP.P1 06	AMLL.P1 06	30	55	33	32	73	8	M10x45
	6,4	1/4"	AMP.P1 6,4	MMP.P1 6,4	RMP.P1 6,4	AMLL.P1 6,4							
	8	5/16"	AMP.P1 08	MMP.P1 08	RMP.P1 08	AMLL.P1 08							
	9,5	3/8"	AMP.P1 9,5	MMP.P1 9,5	RMP.P1 9,5	AMLL.P1 9,5							
	10	1/8"	AMP.P1 10	MMP.P1 10	RMP.P1 10	AMLL.P1 10							
	12		AMP.P1 12	MMP.P1 12	RMP.P1 12	AMLL.P1 12							
	12,7	1/2"	AMP.P1 12,7	MMP.P1 12,7	RMP.P1 12,7	AMLL.P1 12,7							
	13,5	1/4"	AMP.P1 1/4"	MMP.P1 1/4"	RMP.P1 1/4"	AMLL.P1 1/4"							
	14		AMP.P1 14	MMP.P1 14	RMP.P1 14	AMLL.P1 14							
	15		AMP.P1 15	MMP.P1 15	RMP.P1 15	AMLL.P1 15							
	16	5/8"	AMP.P1 16	MMP.P1 16	RMP.P1 16	AMLL.P1 16							
2	17,2	3/8"	AMP.P1 3/8"	MMP.P1 3/8"	RMP.P1 3/8"	AMLL.P1 3/8"	30	70	45	48	102	8	M10x60
	18		AMP.P1 18	MMP.P1 18	RMP.P1 18	AMLL.P1 18							
	19	3/4"	AMP.P2 19	MMP.P2 19	RMP.P2 19	AMLL.P2 19							
	20		AMP.P2 20	MMP.P2 20	RMP.P2 20	AMLL.P2 20							
	21,3	1/2"	AMP.P2 1/2"	MMP.P2 1/2"	RMP.P2 1/2"	AMLL.P2 1/2"							
	22	7/8"	AMP.P2 22	MMP.P2 22	RMP.P2 22	AMLL.P2 22							
	25	1"	AMP.P2 25	MMP.P2 25	RMP.P2 25	AMLL.P2 25							
	25,4		AMP.P2 25,4	MMP.P2 25,4	RMP.P2 25,4	AMLL.P2 25,4							
	26,9	3/4"	AMP.P2 3/4"	MMP.P2 3/4"	RMP.P2 3/4"	AMLL.P2 3/4"							
	28		AMP.P2 28	MMP.P2 28	RMP.P2 28	AMLL.P2 28							
30		AMP.P2 30	MMP.P2 30	RMP.P2 30	AMLL.P2 30								
3	30		AMP.P3 30	MMP.P3 30	RMP.P3 30	AMLL.P3 30	30	85	60	60	140	8	M10x70
	32	1 1/4"	AMP.P3 32	MMP.P3 32	RMP.P3 32	AMLL.P3 32							
	33,7	1"	AMP.P3 1"	MMP.P3 1"	RMP.P3 1"	AMLL.P3 1"							
	35		AMP.P3 35	MMP.P3 35	RMP.P3 35	AMLL.P3 35							
	38	1 1/2"	AMP.P3 38	MMP.P3 38	RMP.P3 38	AMLL.P3 38							
	40		AMP.P3 40	MMP.P3 40	RMP.P3 40	AMLL.P3 40							
	42	1 1/4"	AMP.P3 1 1/4"	MMP.P3 1 1/4"	RMP.P3 1 1/4"	AMLL.P3 1 1/4"							

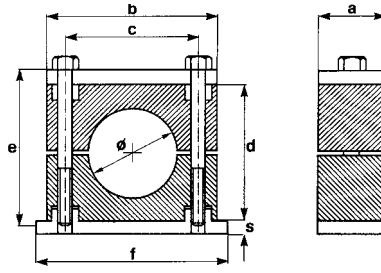

DIN gruppo group	diametro tubo pipe diameter		tipo di collare clamp type				dimensioni in mm dimension in mm							
	Ø mm	pollici / inches G Ø O.D.	AMP.P polipropilene polypropylene	MMP.P polyamide self-extinguishing	RMP.P gomma rubber	AMLL.P alluminio aluminium	a	b	c	d	f	s	e	
4	38	1 1/2"	AMP.P4 38	MMP.P4 38	RMP.P4 38	AMLL.P4 38	45	115	90	90	140	10	M12X100	
	42	1 1/4"	AMP.P4 1 1/4"	MMP.P4 1 1/4"	RMP.P4 1 1/4"	AMLL.P4 1 1/4"								
	44,5	1 3/4"	AMP.P4 44,5	MMP.P4 44,5	RMP.P4 44,5	AMLL.P4 44,5								
	48,3	1 1/2"	AMP.P4 1 1/2"	MMP.P4 1 1/2"	RMP.P4 1 1/2"	AMLL.P4 1 1/2"								
	50		AMP.P4 50	MMP.P4 50	RMP.P4 50	AMLL.P4 50								
	50,8	2"	AMP.P4 50,8	MMP.P4 50,8	RMP.P4 50,8	AMLL.P4 50,8								
	55		AMP.P4 55	MMP.P4 55	RMP.P4 55	AMLL.P4 55								
	57	2 1/4"	AMP.P4 57	MMP.P4 57	RMP.P4 57	AMLL.P4 57								
	60,3	2"	AMP.P4 2"	MMP.P4 2"	RMP.P4 2"	AMLL.P4 2"								
	63,5	2 1/2"	AMP.P4 63,5	MMP.P4 63,5	RMP.P4 63,5	AMLL.P4 63,5								
	65		AMP.P4 65	MMP.P4 65	RMP.P4 65	AMLL.P4 65								
	70	2 3/4"	AMP.P4 70	MMP.P4 70	RMP.P4 70	AMLL.P4 70								
5	65		AMP.P5 65	MMP.P5 65	RMP.P5 65	AMLL.P5 65	60	152	122	120	180	10	M16X130	
	70	2 3/4"	AMP.P5 70	MMP.P5 70	RMP.P5 70	AMLL.P5 70								
	73		AMP.P5 73	MMP.P5 73	RMP.P5 73	-								
	75		AMP.P5 75	MMP.P5 75	RMP.P5 75	AMLL.P5 75								
	76,1	2 1/2"	3"	AMP.P5 2 1/2"	MMP.P5 2 1/2"	RMP.P5 2 1/2"								AMLL.P5 2 1/2"
	80			AMP.P5 80	MMP.P5 80	RMP.P5 80								AMLL.P5 80
	82,5		3 1/4"	AMP.P5 82,5	MMP.P5 82,5	RMP.P5 82,5								AMLL.P5 82,5
	88,9	3"	3 1/2"	AMP.P5 3"	MMP.P5 3"	RMP.P5 3"								AMLL.P5 3"
6	88,9	3"	3 1/2"	AMP.P6 3"	MMP.P6 3"	RMP.P6 3"	-	80	205	168	170	225	15	M20X190
	100			AMP.P6 100	MMP.P6 100	RMP.P6 100	-							
	101,6	3 1/2"	4"	AMP.P6 3 1/2"	MMP.P6 3 1/2"	RMP.P6 3 1/2"	-							
	108		4 1/4"	AMP.P6 108	MMP.P6 108	RMP.P6 108	-							
	114,3	4"	4 1/2"	AMP.P6 4"	MMP.P6 4"	RMP.P6 4"	-							
	127	4 1/2"	5"	AMP.P6 4 1/2"	MMP.P6 4 1/2"	RMP.P6 4 1/2"	-							
7	133		5 1/2"	AMP.P6 133	MMP.P6 133	RMP.P6 133	-	90	250	205	200	270	15	M24X220
	133		5 1/4"	AMP.P7 133	MMP.P7 133	RMP.P7 133	-							
	139,7	5"	5 1/2"	AMP.P7 5"	MMP.P7 5"	RMP.P7 5"	-							
	152,4	5 1/2"	6"	AMP.P7 5 1/2"	MMP.P7 5 1/2"	RMP.P7 5 1/2"	-							
	165		6 1/2"	AMP.P7 165	MMP.P7 165	RMP.P7 165	-							
8	168,3	6"		AMP.P7 6"	MMP.P7 6"	RMP.P7 6"	-	120	320	265	270	340	25	M30X300
	168,3	6"		AMP.P8 6"	-	-	-							
	177,8		7"	AMP.P8 177,8	-	-	-							
	193,7		7 5/8"	AMP.P8 193,7	-	-	-							
	216		8 1/2"	AMP.P8 216	-	-	-							
219,1	8"		AMP.P8 8"	-	-	-								



tipo H interno liscio
H model smooth inside

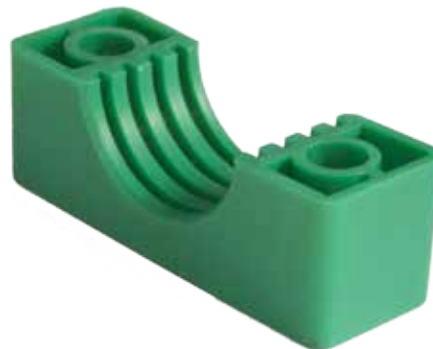

tipo normale interno sagomato
normal model profiled inside

DIN gruppo group	semi-collare clamp-half	DIN gruppo group	semi-collare clamp-half	DIN gruppo group	semi-collare clamp-half
1	AMP.P1 06 S	4	AMP.P4 38 S	7	AMP.P7 133 S
	AMP.P1 6,4 S		AMP.P4 11/4" S		AMP.P7 5" S
	AMP.P1 08 S		AMP.P4 44,5 S		AMP.P7 5 1/2" S
	AMP.P1 9,5 S		AMP.P4 11/2" S		AMP.P7 165 S
	AMP.P1 10 S		AMP.P4 50 S		AMP.P7 6" S
	AMP.P1 12 S		AMP.P4 50,8 S		AMP.P8 6" S
	AMP.P1 12,7 S		AMP.P4 55 S		AMP.P8 177,8 S
	AMP.P1 1/4" S		AMP.P4 57 S		AMP.P8 193,7 S
	AMP.P1 14 S		AMP.P4 2" S		AMP.P8 216 S
	AMP.P1 15 S		AMP.P4 63,5 S		AMP.P8 8" S
	AMP.P1 16 S		AMP.P4 65 S		
AMP.P1 3/8" S	AMP.P4 70 S				
AMP.P1 18 S	AMP.P5 65 S				
2	AMP.P2 19 S	5	AMP.P5 70 S		
	AMP.P2 20 S		AMP.P5 73 S		
	AMP.P2 1/2" S		AMP.P5 75 S		
	AMP.P2 22 S		AMP.P5 2 1/2" S		
	AMP.P2 25 S		AMP.P5 80 S		
	AMP.P2 25,4 S		AMP.P5 82,5 S		
	AMP.P2 3/4" S		AMP.P5 3" S		
	AMP.P2 28 S		AMP.P6 3" S		
AMP.P2 30 S	AMP.P6 100 S				
3	AMP.P3 30 S	6	AMP.P6 3 1/2" S		
	AMP.P3 32 S		AMP.P6 108 S		
	AMP.P3 1" S		AMP.P6 4" S		
	AMP.P3 35 S		AMP.P6 4 1/2" S		
	AMP.P3 38 S		AMP.P6 133 S		
	AMP.P3 40 S				
AMP.P3 1 1/4" S					



tipo H interno liscio
H model smooth inside



tipo normale interno sagomato
normal model profiled inside

DIN gruppo group	coppia collare pair of halves	DIN gruppo group	coppia collare pair of halves	DIN gruppo group	coppia collare pair of halves
1	AMP.P1 06 C	4	AMP.P4 38 C	7	AMP.P7 133 C
	AMP.P1 6,4 C		AMP.P4 11/4" C		AMP.P7 5" C
	AMP.P1 08 C		AMP.P4 44,5 C		AMP.P7 5 1/2" C
	AMP.P1 9,5 C		AMP.P4 11/2" C		AMP.P7 165 C
	AMP.P1 10 C		AMP.P4 50 C		AMP.P7 6" C
	AMP.P1 12 C		AMP.P4 50,8 C		AMP.P8 6" C
	AMP.P1 12,7 C		AMP.P4 55 C		AMP.P8 177,8 C
	AMP.P1 1/4" C		AMP.P4 57 C	8	AMP.P8 193,7 C
	AMP.P1 14 C		AMP.P4 2" C	AMP.P8 216 C	
	AMP.P1 15 C		AMP.P4 63,5 C	AMP.P8 8" C	
	AMP.P1 16 C		AMP.P4 65 C		
	AMP.P1 3/8" C		AMP.P4 70 C		
	AMP.P1 18 C		AMP.P5 65 C		
	AMP.P2 19 C		AMP.P5 70 C		
AMP.P2 20 C	AMP.P5 73 C				
AMP.P2 1/2" C	AMP.P5 75 C				
AMP.P2 22 C	5	AMP.P5 2 1/2" C			
AMP.P2 25 C	AMP.P5 80 C	AMP.P5 82,5 C			
AMP.P2 25,4 C	AMP.P5 82,5 C	AMP.P5 3" C			
AMP.P2 3/4" C	AMP.P6 3" C				
AMP.P2 28 C	AMP.P6 100 C				
AMP.P2 30 C	AMP.P6 3 1/2" C				
AMP.P3 30 C	6	AMP.P6 108 C			
AMP.P3 32 C	AMP.P6 108 C	AMP.P6 4" C			
AMP.P3 1" C	AMP.P6 4 1/2" C	AMP.P6 133 C			
3	AMP.P3 35 C				
AMP.P3 38 C					
AMP.P3 40 C					
AMP.P3 1 1/4" C					

APINP

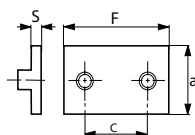

DIN gruppo group	piastra inferiore lower plate				
	APINP	a mm	F mm	c mm	S mm
1	APINP1	30	77	33	8
2	APINP2	30	87	45	8
3	APINP3	30	103	60	8
4	APINP4	45	140	90	10
5	APINP5	60	180	122	10
6	APINP6	80	225	168	15
7	APINP7	90	270	205	15
8	APINP8	120	340	265	25

APSP

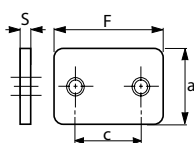

DIN gruppo group	piastra superiore upper plate				
	APSP	a mm	F mm	c mm	S mm
1	APSP1	30	55	33	8
2	APSP2	30	70	45	8
3	APSP3	30	85	60	8
4	APSP4	45	120	90	10
5	APSP5	60	152	122	10
6	APSP6	80	205	168	15
7	APSP7	90	250	205	15
8	APSP8	120	320	265	25

AVTEP

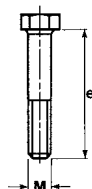

DIN gruppo
group vite a testa esagonale
hexagonal head screw

	AVTEP	M	e mm
1	AVTEP1	M10	45
2	AVTEP2	M10	60
3	AVTEP3	M10	70
4	AVTEP4	M12	100
5	AVTEP5	M16	130
6	AVTEP6	M20	190
7	AVTEP7	M24	220
8	AVTEP8	M30	300

AVTEAP

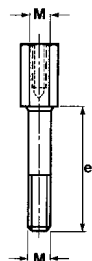

DIN gruppo
group vite a testa esagonale
hexagonal head screw

	AVTEAP	M	e mm
1	AVTEAP1	M10	26
2	AVTEAP2	M10	41
3	AVTEAP3	M10	52
4	AVTEAP4	M12	83
5	AVTEAP5	M16	110

APMRSP

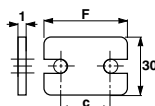

DIN gruppo
group

*piastra superiore di sicurezza
security upper plate*

	APMRSP	a mm	F mm	c mm	S mm
1	APMRSP1	30	55	33	8
2	APMRSP2	30	70	45	8
3	APMRSP3	30	85	60	8
4	APMRSP4	45	120	90	10
5	APMRSP5	60	152	122	10

ABINP

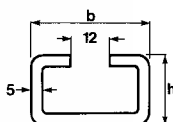

DIN gruppo
group

*binari portanti
spessore 5 mm rail*

	ABINP	b mm	h mm
1	ABINP1	40	22

ADESP

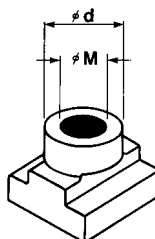

DIN gruppo
group

*dado fissaggio binari
rail nut*

	ADESP	M	\varnothing mm
1	ADESP1	M10	18
2	ADESP2	M12	20

Piastre doppie per serie pesante

Double plates for heavy duty series

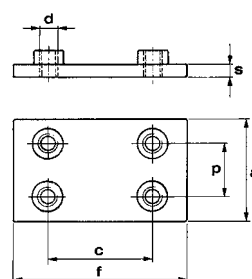
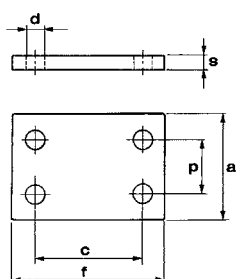

piastra superiore pesante doppia
heavy duty double upper plate

DIN gruppo group	APSPD	a	f	s	c	p	d
		mm	mm	mm	mm	mm	mm
1	APSPD1	60	55	8	33	31	11
2	APSPD2	60	70	8	45	31	11
3	APSPD3	60	85	8	60	31	11
4	APSPD4	90	120	10	90	46	14
5	APSPD5	120	154	10	122	61	18

piastra inferiore pesante doppia
heavy duty double lower plate

DIN gruppo group	APINPD	a	f	s	c	p	m
		mm	mm	mm	mm	mm	m
1	APINPD1	60	77	8	33	31	M10
2	APINPD2	60	87	8	45	31	M10
3	APINPD3	60	103	8	60	31	M10
4	APINPD4	90	140	10	90	46	M12
5	APINPD5	120	180	10	122	61	M16

Supporto tra tubo e cilindro

Double plates for heavy duty series

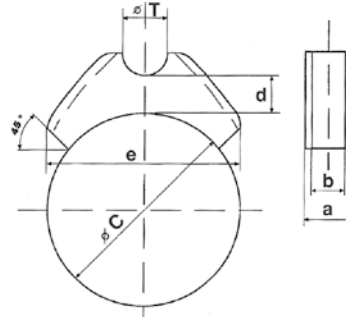

DIN gruppo group	codice code	tipo di collare clamp type		Ø tubo T Ø tube T		dimensioni in mm dimension in mm			
		mm	inc. O.D.	mm	inc. O.D.	a	b	c	d
1	STF 12/50-70	50 ÷ 70	1,96 ÷ 2,75	12	0,47	23	14	12	72
	STF 12/60-80	60 ÷ 80	2,36 ÷ 3,15						
	STF 12/70-90	70 ÷ 90	2,75 ÷ 3,54						
	STF 12/80-100	80 ÷ 100	3,15 ÷ 3,94						
	STF 12/90-110	90 ÷ 110	3,54 ÷ 4,33						
	STF 12/100-120	100 ÷ 120	3,94 ÷ 4,72						
	STF 12/110-130	110 ÷ 130	4,33 ÷ 5,12						
	STF 12/125-150	125 ÷ 150	4,92 ÷ 5,90						
	STF 12/145-170	145 ÷ 170	5,71 ÷ 6,69						
	STF 12/165-200	165 ÷ 200	6,49 ÷ 7,87						
2	STF 20/50-70	50 ÷ 70	1,96 ÷ 2,75	20	0,78	23	14	12	72
	STF 20/60-80	60 ÷ 80	2,36 ÷ 3,15						
	STF 20/70-90	70 ÷ 90	2,75 ÷ 3,54						
	STF 20/80-100	80 ÷ 100	3,15 ÷ 3,94						
	STF 20/90-110	90 ÷ 110	3,54 ÷ 4,33						
	STF 20/100-120	100 ÷ 120	3,94 ÷ 4,72						
	STF 20/110-130	110 ÷ 130	4,33 ÷ 5,12						
	STF 20/125-150	125 ÷ 150	4,92 ÷ 5,90						
	STF 20/145-170	145 ÷ 170	5,71 ÷ 6,69						
	STF 20/165-200	165 ÷ 200	6,49 ÷ 7,87						
3	STF 25/50-70	50 ÷ 70	1,96 ÷ 2,75	25	0,98	23	14	12	72
	STF 25/60-80	60 ÷ 80	2,36 ÷ 3,15						
	STF 25/70-90	70 ÷ 90	2,75 ÷ 3,54						
	STF 25/80-100	80 ÷ 100	3,15 ÷ 3,94						
	STF 25/90-110	90 ÷ 110	3,54 ÷ 4,33						
	STF 25/100-120	100 ÷ 120	3,94 ÷ 4,72						
	STF 25/110-130	110 ÷ 130	4,33 ÷ 5,12						
	STF 25/125-150	125 ÷ 150	4,92 ÷ 5,90						
	STF 25/145-170	145 ÷ 170	5,71 ÷ 6,69						
	STF 25/165-200	165 ÷ 200	6,49 ÷ 7,87						

Applicazioni: Oleodinamica e pneumatica - Macchine utensili - Macchine movimento terra - Macchine agricole - Industria meccanica - Industria in generale - ecc.

Applications: oleodynamic and pneumatic - Machines tools - Earth-moving machines - Farmmachines - Mechanical and metallurgical industry - Oil industry - and so on.

Caratteristiche materiali

Materials properties

	Metodo di prova <i>Test method</i>	Unità di misura <i>Units</i>
FISICHE Physical		
Peso specifico <i>Specific gravity</i>	ASTM D 792	g/cm ³
Assorbimento d'acqua (24h a 23°C in immersione) <i>Water absorption (24h at 23°C immersion)</i>	ASTM D 570	%
Ritiro lineare allo stampaggio <i>Mould shrinkage</i>	ASTM D 955	%
MECCANICHE Mechanical		
Carico di snervamento a trazione <i>Tensile strenght at yield</i>	ASTM D 638	N/mm ²
Carico di rottura a trazione <i>Tensile strenght</i>	ASTM D 638	N/mm ²
Modulo elastico a trazione <i>Tensile modulus</i>	ASTM D 638	N/mm ²
Allungamento alla rottura <i>Ultimate elongation</i>	ASTM D 638	%
Resistenza all'urto con intaglio IZOD 6.4 mm <i>IZOD impact strenght notched 6.4 mm</i>	ASTM D 256	J/m
Durezza Rockwell, scala R + L <i>Rockwell hardness, scale R + L</i>	ASTM D 785	—
TERMICHE Thermal		
Temperatura di inflessione 1.82 N mm ² <i>H.D.T. - heat distorsion temperature 1.82 N mm²</i>	ASTM D 648	°C
Temperatura di fusione <i>Melting point</i>	ASTM D 789	°C
Coefficiente di espansione termico lineare <i>Coefficient of linear thermal expansion</i>	ASTM D 696	°C
Autoestinguenza <i>Flammability</i>	UL 94	—
Temperatura max. d'esercizio <i>Max. exercise temperature</i>	—	°C
ELETTRICHE Electrical		
Rigidità dielettrica - spessore 3 mm <i>Dielectric strenght - thickness 3 mm</i>	ASTM D 149	kV/mm
Costante dielettrica a 1 kHz <i>Dielectric constant, 1kHz</i>	ASTM D 150	—
Resistività di volume <i>Volume resistivity</i>	ASTM D 257	Phm. cm ²
Fattore di dissipazione a 1 kHz <i>Dissipation factor, 1 kHz</i>	DIN 53483	—
Resistenza alle correnti striscianti KA sol. A <i>Tracking resistance KA sol. A</i>	DIN 53480	—
Resistenza alle correnti striscianti KB sol. A <i>Tracking resistance KB sol. A</i>	DIN 53480	V
Resistenza alle correnti striscianti KC sol. F <i>Tracking resistance KC sol. F</i>	DIN 53480	V

Polipropilene Copolimero <i>Meterophasic Copolymers</i>	Poliammide 6-6 <i>Polyamide 6-6</i>	Gomma termoplastica <i>Thermoplastic Rubber</i>	Alluminio <i>Aluminium</i>
0,9	1,34	0,964	2,67 kg/dm ³
Not possible	1	Not possible	Not possible
1,5 ÷ 2,4	0,2 ÷ 0,5	0,4 ÷ 0,8	0,7%
27	80	6,8 EN 1706	MPA 140
Not available	150	1400	170 ÷ 220
1400	8200	530	68000 ÷ 78000
12	3	750	EN 1706 %1
85	70	80 SHORE A	Not available
R84	(L) 150		Brinell en 1706 HBW 80
88	240	70 ÷ 90	380 °C
150	258	151°, 1 °C	380
0,00012	2,5 - 10 ⁵	160 Nm/mk	24 - 10 - 5 (1,6mm: nero/black)
Not available	V-0  (1,6mm: nero/black)	Not available	Not available
-30 +90	-40 +180	-40 +80	+350
Not available	20	Not available	20
10 ¹⁸	4,5	2,2 - 2,5	Not available
10 ¹⁶	4,5 - 1015	Not available	4,5 - 1015
0,0002	0,018	Not available	Not available
3C	KA 3b	KA 3b	KA 3b
> 680	450	Not available	Not available
> 600	450	Not available	450