

BM150

Single section valve

Flow 140 l/min

Ports threads 3/4" BSP /

SAE 12

2 Inlet and Outlet ports

Prepared for High
pressure Carry Over

(Power Beyond)

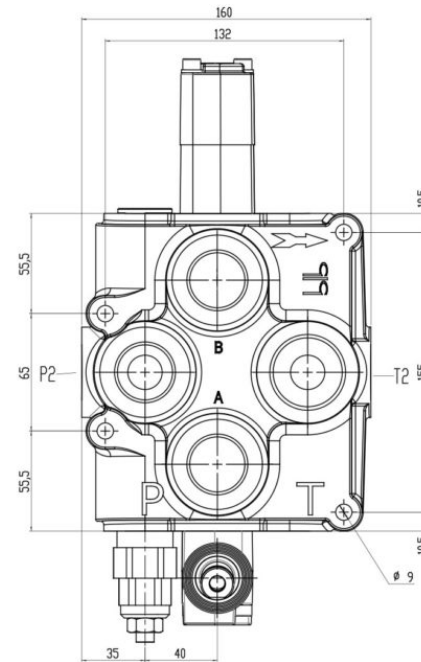
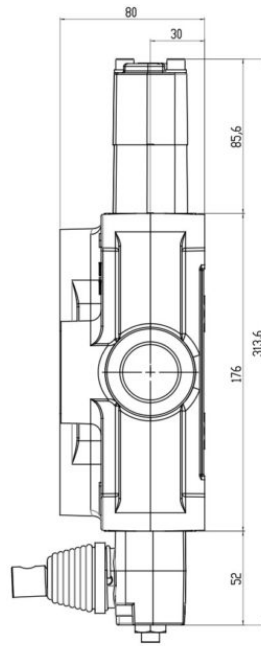

SPECIFICHE TECNICHE / TECHNICAL SPECIFICATIONS

PORTATA NOMINALE / NOMINAL FLOW	140 L/min	37 GPM
PORTATA MAX / MAX FLOW	180 L/min	48 GPM
PRESSIONE NOMINALE / NOMINAL PRESSURE	250 bar	3600 PSI
PRESSIONE MAX SUGLI UTILIZZI / MAX PRESSURE ON PORTS	320 bar	4700 PSI

FILETTATURE STANDARD / STANDARD THREADS

	A - B	P	T	P2	T2
G (BSP)	3/4"	3/4"	3/4"	1"	1"
F (UNF - SAE 12)	1,1/16"-12	1,1/16"-12	1,1/16"-12	1,5/16"-12	1,5/16"-12

SPECIFICHE TECNICHE / TECHNICAL SPECIFICATIONS

CONTROPRESSIONE MAX ALLO SCARICO / MAX PRESSURE ON TANK LINE	80 bar	1100 PSI
--	--------	-------------

TRAFILAMENTI INTERNI / INTERNAL OIL LEAKAGE

A - B → T	4 ÷ 8 cc/min
-----------	-----------------

CONDIZIONI DI TEST / TESTING CONDITIONS

PRESSIONE / PRESSURE	100 bar
TEMPERATURA DELL'OLIO / OIL TEMPERATURE	40 °C
VISCOSITÀ DELL'OLIO / OIL VISCOSITY	32 mm ² /s

DIMENSIONI / DIMENSIONS

N. DI SEZIONI N. OF SECTIONS	L		l	
	mm	inch	mm	inch
BM150	160	6,30	132	5,20

PERDITE DI CARICO / PRESSURE DROP

